

PLAN SCALE 1:5,000

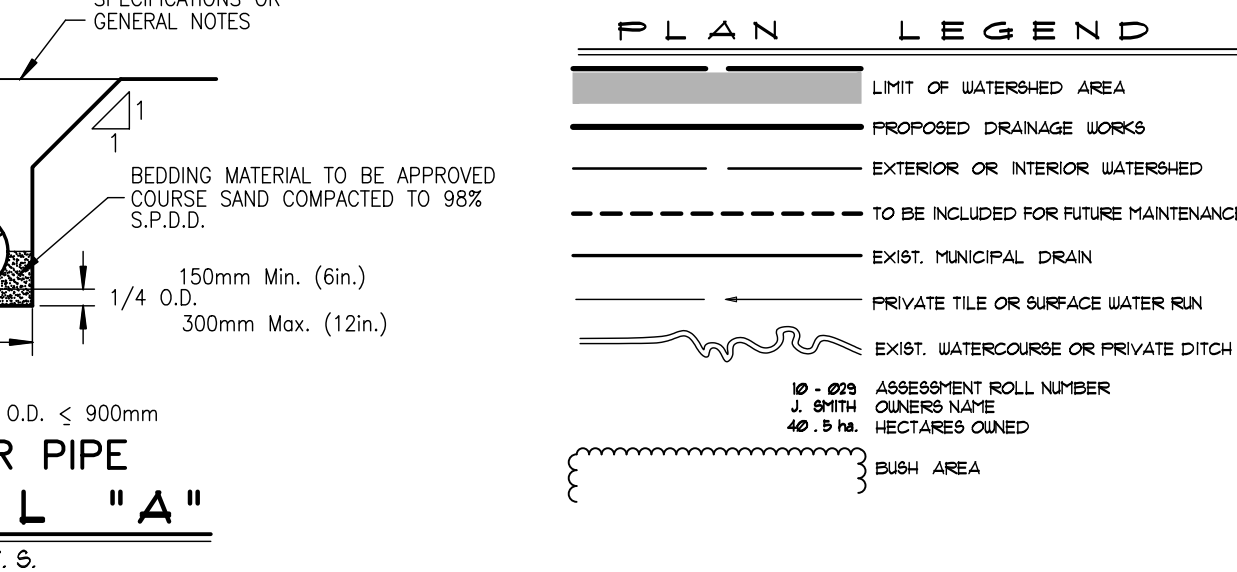
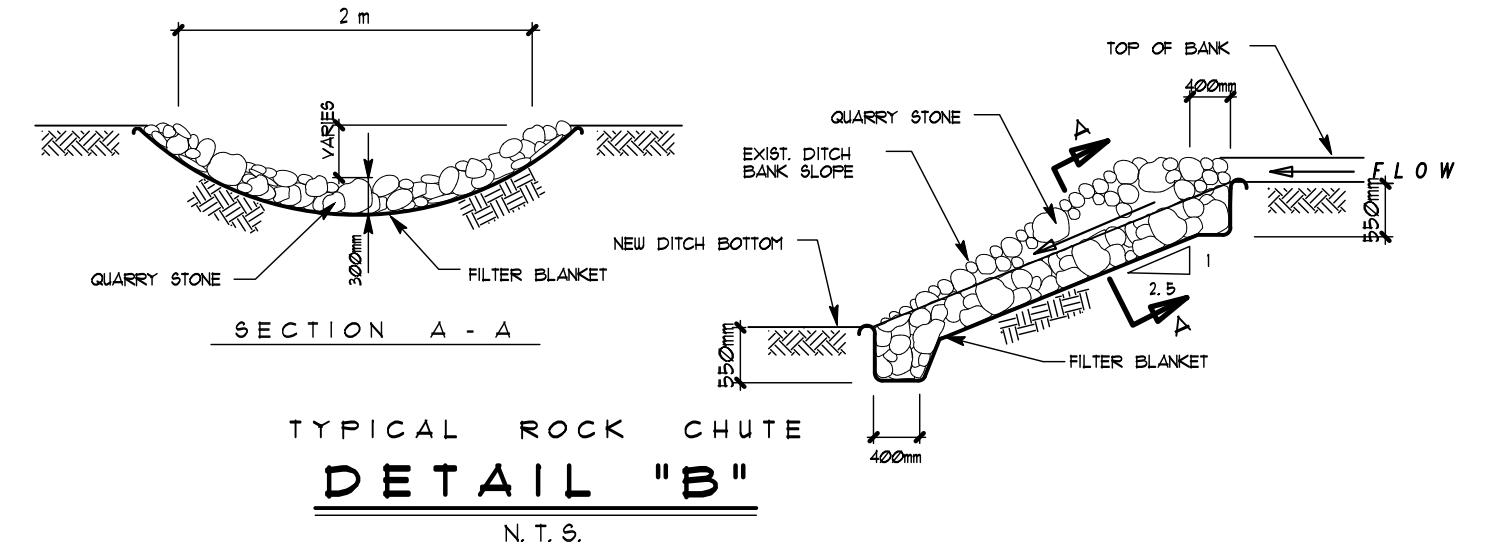
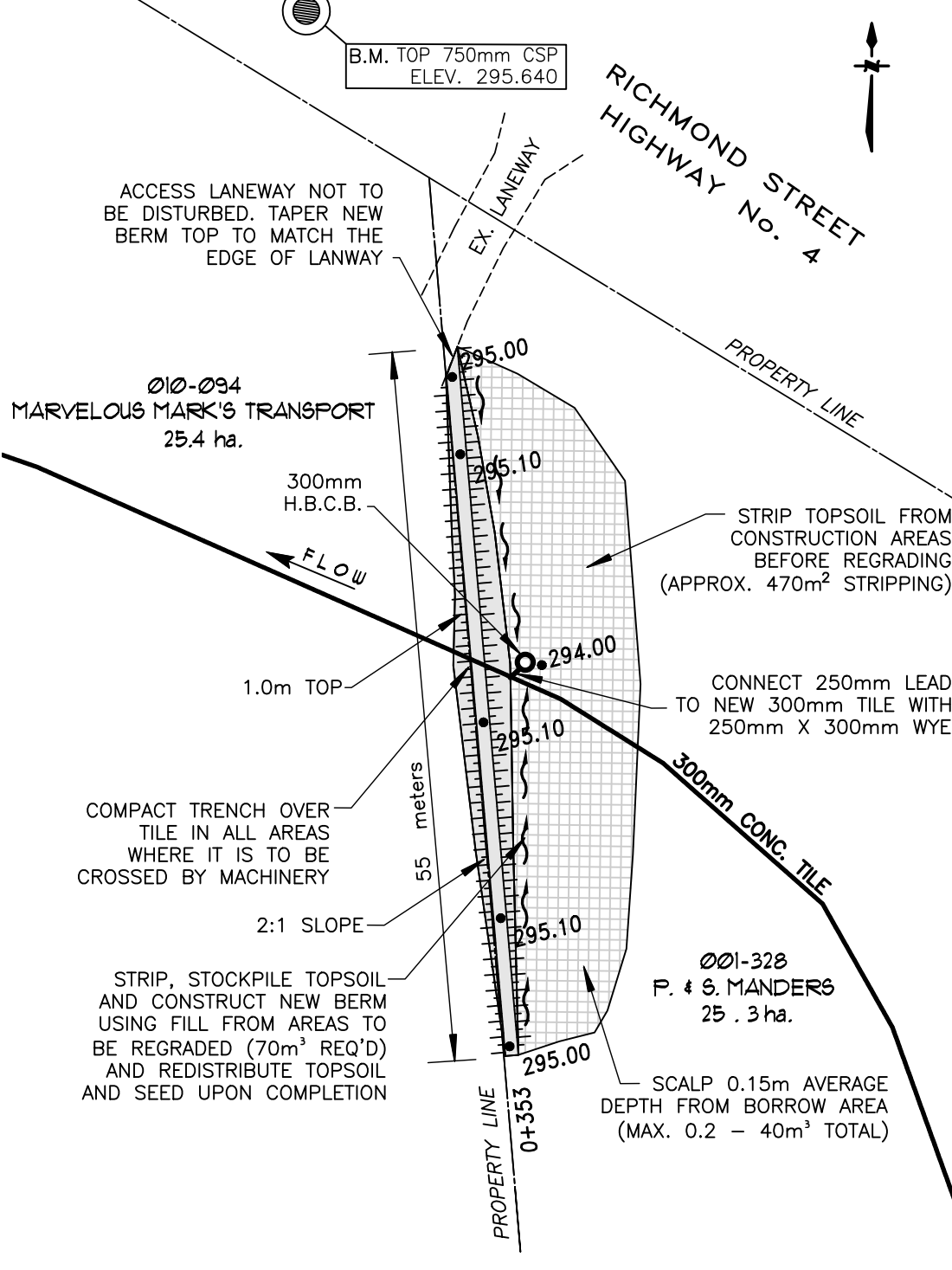
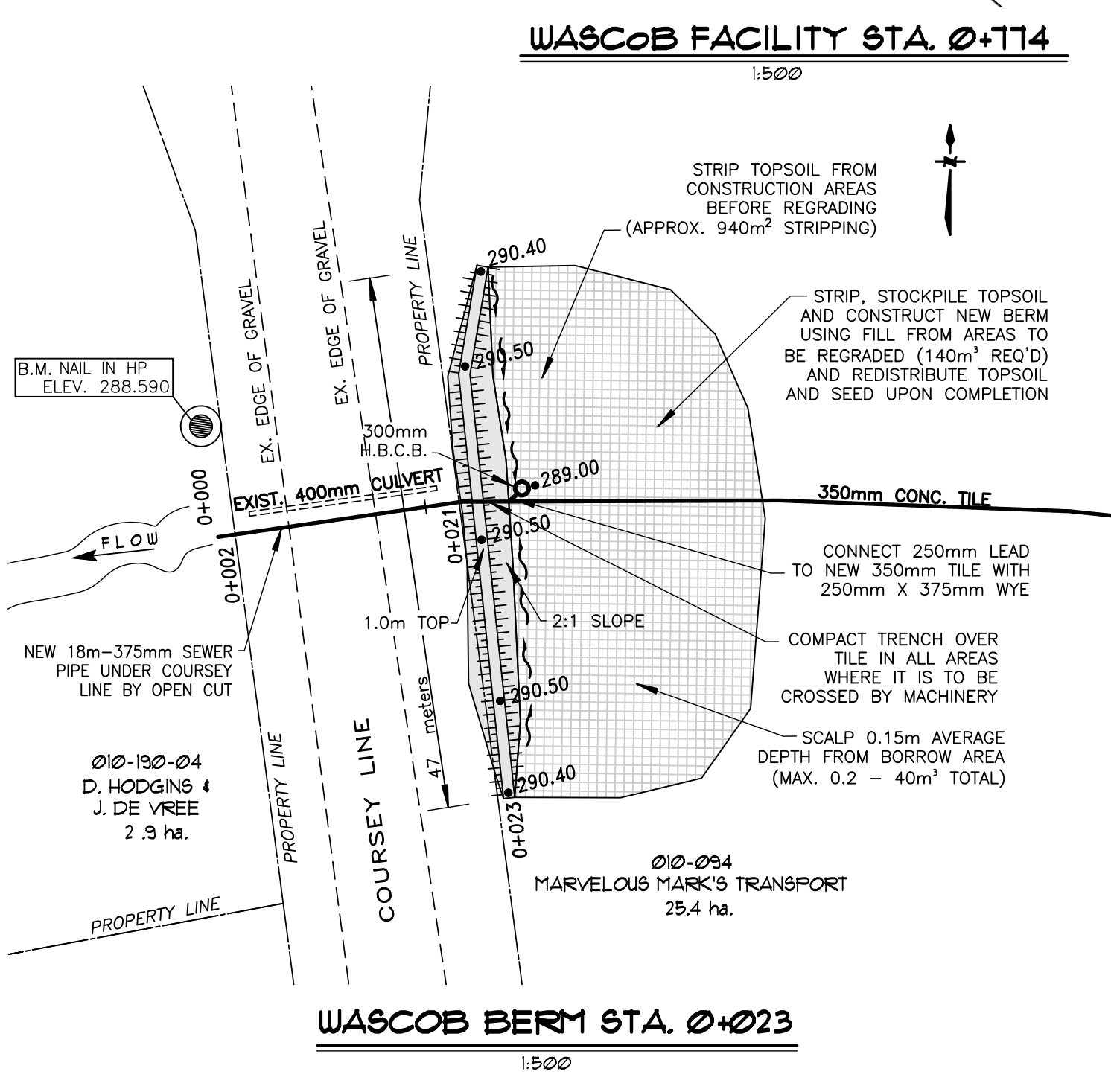

GENERAL NOTES

- OUR SPECIFICATIONS DATED JANUARY 2020 APPLY TO THIS PROJECT.
- THE WORKING WIDTH AVAILABLE TO THE CONTRACTOR TO CONSTRUCT THE NEW DRAINS SHALL CONSIST OF THOSE LANDS IMMEDIATELY ADJACENT TO THE DRAIN AND CONNECTIONS AND SHALL NOT EXCEED THE FOLLOWING AVERAGE WIDTHS:
CLOSED PORTIONS - 20 METERS
THE WORKING WIDTH FOR PURPOSES OF FUTURE MAINTENANCE SHALL BE THE SAME AS ABOVE EXCEPT FOR CLOSED PORTIONS WHICH SHALL BE 10m. THE WASCOB AREAS SHALL BE INCLUDED FOR FUTURE MAINTENANCE PURPOSES.
- ALL OWNERS ALONG THE COURSE OF THE DRAIN SHALL MAKE AN ACCESS ROUTE FROM THE NEAREST ROAD TO THE DRAIN LOCATION AVAILABLE TO THE CONTRACTOR THE AVERAGE WIDTH OF THIS ROUTE SHALL NOT EXCEED 8 METERS. THE ACCESS ROUTE SHALL ALSO APPLY FOR FUTURE MAINTENANCE PURPOSES.
- a) ALL UTILITIES TO BE LOCATED AND EXPOSED PRIOR TO CONSTRUCTION SO THAT THE NEW TILE GRADES CAN BE CONFIRMED, IF THERE IS A CONFLICT IN ELEVATION BETWEEN THE PROPOSED DRAIN AND THE UTILITY, THE ENGINEER IS TO BE NOTIFIED IMMEDIATELY.
b) CONTRACTOR TO NOTIFY ALL UTILITIES 12 HOURS PRIOR TO HIS SCHEDULED TIME FOR STARTING THE ABOVE WORK.
c) THE COST FOR THIS WORK SHALL BE INCLUDED IN THE ITEM ON THE EXTENT OF WORK AND NO EXTRA PAYMENT SHALL BE MADE TO THE CONTRACTOR, EXCEPT IF ROAD RESTORATION IS REQUIRED.

- ALL TREES, SCRUB, BRUSH, ETC. TO BE CLEARED AND GRUBBED IN ACCORDANCE WITH "SECTION B.3 AND C.4" SPECIFICATIONS.
- RIP-RAP TO BE SUPPLIED AND INSTALLED IN ACCORDANCE WITH "SECTION A.12" IN THE SPECIFICATIONS.
- CONTRACTOR TO ARRANGE A PRE-CONSTRUCTION MEETING WITH THE ENGINEER, DRAINAGE SUPERINTENDENT, AND THE AFFECTED OWNERS. ALL PARTIES SHALL RECEIVE 48 HOURS NOTICE TO THE MEETING.
- CLOSED PORTIONS**
 - ALL CONCRETE AND PLASTIC TILE AND PIPE TO CONFORM TO "SECTION C.1" IN THE SPECIFICATIONS.
 - SEWER PIPE TO BE CONCRETE, H.D.P.E. PLASTIC 320 KPA (BELL & SPIGOT WITH RUBBER GASKETS, CONFORMING TO C.S.A. 1076-00), PVC ULTRA RIB OR PVC SDR 35
 - CONCRETE TILE SHALL BE HEAVY DUTY, UNLESS SPECIFIED AS 2000 D OR 2400 D ON PROFILE.
- ALL CATCHBASINS SHALL BE SUPPLIED AND INSTALLED IN ACCORDANCE WITH "SECTION C.16" IN THE SPECIFICATIONS, EXCEPT AS FOLLOWS:
 - ALL CATCHBASIN & HICKENBOTTOM LEADS TO BE CONNECTED TO NEW TILE DRAIN WITH PRE-FABRICATED "WYE"

- NEW TILE DRAINS TO BE LOCATED AS FOLLOWS:
MAIN DRAIN
a) STA. 0+000 TO STA. 0+175 AND 0+330 TO 0+335 - NEW TILE DRAIN TO BE PLACED IN SAME LOCATION AS EXISTING TILE DRAIN WHERE POSSIBLE. EXIST. TILE TO BE DESTROYED AND EXPOSED TILE SHALL BE DISPOSED OF OFF-SITE.
b) STA. 0+175 TO STA. 0+330 - EXACT LOCATION TO BE IN ACCORDANCE WITH DIMENSIONS SHOWN ON PLAN AND CONFIRMED BY DRAINAGE SUPERINTENDENT OR ENGINEER AT TIME OF CONSTRUCTION.
EXISTING TILE DRAINS TO BE EXPOSED IN AS MANY LOCATIONS AS ARE NECESSARY TO CONFIRM THEIR EXACT LOCATION AND ELEVATION PRIOR TO CONSTRUCTION, EXACT LOCATION OF NEW TILE DRAINS THEN TO BE CONFIRMED BY DRAINAGE SUPERINTENDENT OR ENGINEER.
- INSTALLATION OF TILE AND TRENCH WIDTHS SHALL BE IN ACCORDANCE WITH "SECTION C - TILE DRAIN" IN THE SPECIFICATIONS.
SEWER PIPE UNDER TRAVEL PORTION OF ROADS TO BE INSTALLED IN ACCORDANCE WITH STANDARD DETAILED DRAWING No. 02 IN THE SPECIFICATIONS.
c) ALL OTHER SEWER PIPE TO BE INSTALLED IN ACCORDANCE WITH DETAIL "A"
d) ALL CONCRETE TILE AND TILE-PIPE JOINTS TO BE WRAPPED WITH GEOTEXTILE IN ACCORDANCE WITH "SECTION C.8" IN THE SPECIFICATIONS.

- NO CONSTRUCTION EQUIPMENT OR FARM MACHINERY SHALL CROSS OVER THE MOUNDED BACKFILLED TILE TRENCHES UNTIL SUFFICIENT SETTLEMENT HAS OCCURRED.
- STRIP AND STOCKPILE TOPSOIL FROM CONSTRUCTION AREA (4 METRE WIDTH) EXCEPT LANEWAYS & ROADS. EXCESS SPOIL TO BE LEVELLED, AND TOPSOIL RELEVELLED OVER SPOIL, MOUNDED TRENCH AND REMAINING CONSTRUCTION AREA.
- a) THE CONTRACTOR SHALL ENSURE THAT ALL TRIBUTARY DRAINS ARE CONNECTED DURING TIME OF CONSTRUCTION - ANY MISSED TILE CONNECTIONS THAT ARE FOUND DURING THE WARRANTY PERIOD OF THE CONTRACT SHALL BE COMPLETED BY THE CONTRACTOR AND SHALL BE PAID THE AMOUNT SET OUT ON PAGE 2 OF THE "FORM OF TENDER". NO ADDITIONAL PAYMENT FOR MOBILIZATION WILL BE ALLOWED. THE CONTRACTOR IS NOT RESPONSIBLE FOR COMPLETING MISSED TILE CONNECTIONS THAT ARE FOUND AFTER THE WARRANTY PERIOD FOR THE CONTRACT HAS EXPIRED.
b) ALL TILE CONNECTIONS TO BE MADE WITH CORING MACHINE AND PLASTIC ADAPTOR OR PREFABRICATED FITTINGS.
c) THE CONTRACTOR SHALL SUPPLY THE ENGINEER WITH A LIST SHOWING STATIONS OF ALL TILE CONNECTIONS UPON COMPLETION OF CONSTRUCTION.

HARDY DRAIN NORTH 2021
Township of Lucan Biddulph

Drainage Superintendent:
ALEX VERBEEK
519-672-4100

No.	REVISIONS	DATE

Drawn By: TF
Date: DEC. 03, 2021

Field Book: D - 266
JOB No.: 220190
Drawing No.: 1 of 1

PLAN, PROFILES, & DETAIL

SPRIET ASSOCIATES LIMITED CONSULTING ENGINEERS
155 YORK STREET - LONDON (519) 672-4100 - NEA 1A8